

Robt Crawford. Sec A-53-30221
+ A-56-87

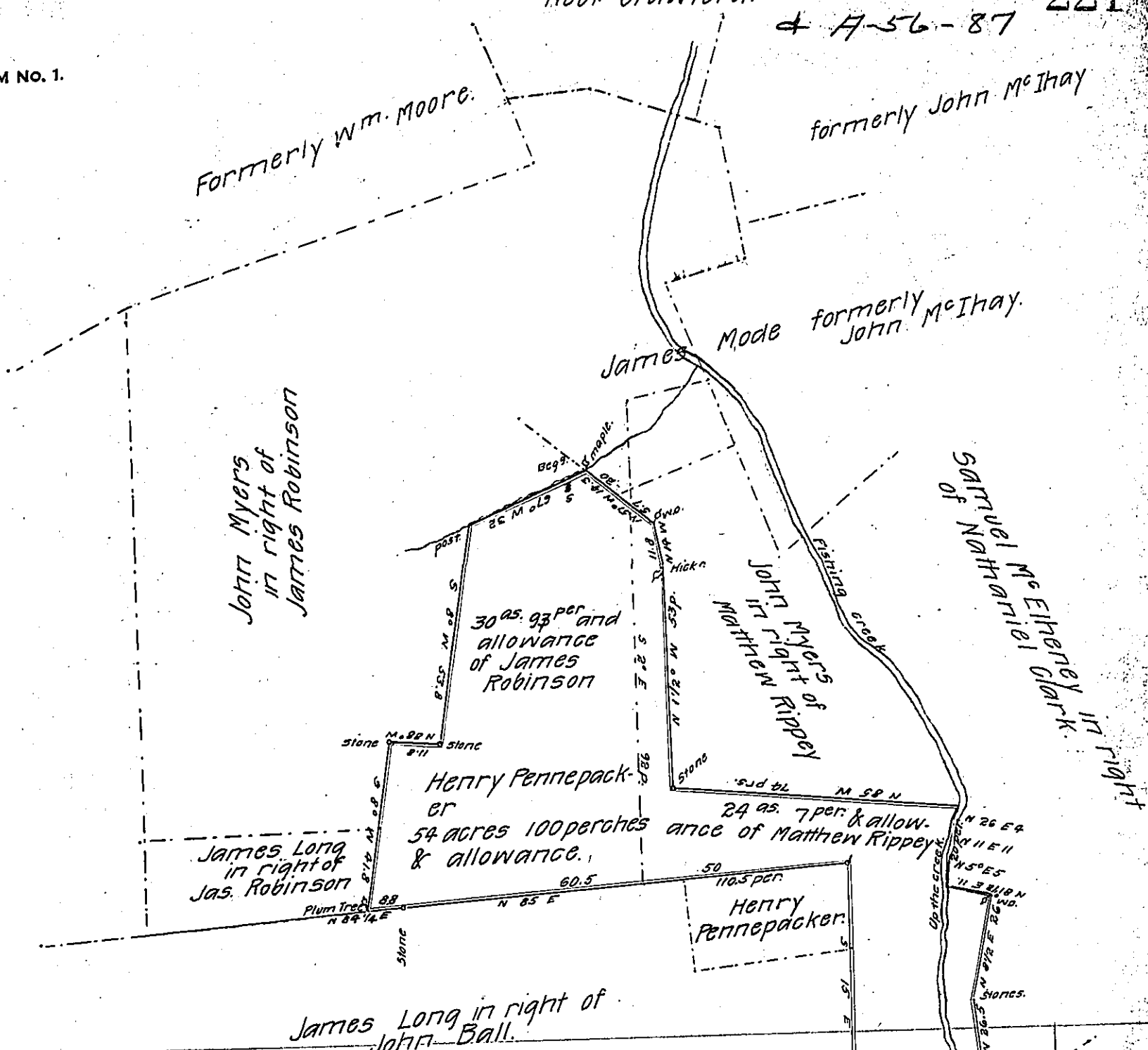

The above Draught represents the lines of a tract of Fifty four acres and one hundred perches of land and the usual allowance of six acres per cent for roads &c. Being composed of Parts of two adjoining tracts the larger one surveyed about the year 1738, in pursuance of a warrant dated the 3^d day of July A.D. 1736, granted to James Robinson, the other was surveyed the 26th of April A.D. 1753, in pursuance of a warrant bearing date the 17th day of April A.D. 1752, granted to Matthew Rippey, Situate in Drumore township Lancaster County, Penna. Surveyed for Henry Pennepacker, the 20th day of April A.D. 1853. P. A. Dubree, for the Surveyor of Lancaster County;

Approved of the above survey, May 19th 1853.
Henry H. Kurtz, Sur^r Lancaster County.

IN TESTIMONY that the above is a copy of the original remaining on file in the Department of Internal Affairs of Pennsylvania, made comformably to an Act of Assembly approved the 16th day of February 1833, I have hereunto set my hand and caused the Seal of said Department to be affixed at Harrisburg, this third day of January 1908

Henry H. Kurtz
Secretary of Internal Affairs.